

RQL Series

Features

- 105°C, 10,000 hours assured
- 10 φ ~ 18 φ with large permissible ripple current
- Slim type included
- RoHS compliance



Specifications

Items	Performance																					
	Category Temperature Range	400V -40°C ~ +105°C		420 ~ 450V -25°C ~ +105°C																		
Capacitance Tolerance	±20% (at 120 Hz, 20°C)																					
Leakage Current (at 20°C)	<table border="1"> <thead> <tr> <th>Time</th> <th colspan="4">after 5 minutes</th> </tr> </thead> <tbody> <tr> <td>Leakage Current</td> <td>CV ≤ 1,000 I = 0.03CV + 15(μA)</td> <td>420</td> <td>450</td> <td>CV > 1,000 I = 0.02CV + 25(μA)</td> <td></td> </tr> </tbody> </table> <p>Where, C = rated capacitance in μF, V = rated DC working voltage in V</p>					Time	after 5 minutes				Leakage Current	CV ≤ 1,000 I = 0.03CV + 15(μA)	420	450	CV > 1,000 I = 0.02CV + 25(μA)							
Time	after 5 minutes																					
Leakage Current	CV ≤ 1,000 I = 0.03CV + 15(μA)	420	450	CV > 1,000 I = 0.02CV + 25(μA)																		
Tanδ (at 120 Hz, 20°C)	<table border="1"> <thead> <tr> <th>Rated Voltage</th> <th>400</th> <th>420</th> <th>450</th> <th></th> <th></th> </tr> </thead> <tbody> <tr> <td>Tanδ (max)</td> <td>0.24</td> <td>0.24</td> <td>0.24</td> <td></td> <td></td> </tr> </tbody> </table>					Rated Voltage	400	420	450			Tanδ (max)	0.24	0.24	0.24							
Rated Voltage	400	420	450																			
Tanδ (max)	0.24	0.24	0.24																			
Low Temperature Characteristics (at 120 Hz)	<p>Impedance ratio shall not exceed the values given in the table below.</p> <table border="1"> <thead> <tr> <th colspan="2">Rated Voltage</th> <th>400</th> <th>420</th> <th>450</th> <th></th> </tr> </thead> <tbody> <tr> <td rowspan="2">Impedance Ratio</td> <td>Z(-25°C)/Z(+20°C)</td> <td>5</td> <td>6</td> <td>6</td> <td></td> </tr> <tr> <td>Z(-40°C)/Z(+20°C)</td> <td>6</td> <td>-</td> <td>-</td> <td></td> </tr> </tbody> </table>					Rated Voltage		400	420	450		Impedance Ratio	Z(-25°C)/Z(+20°C)	5	6	6		Z(-40°C)/Z(+20°C)	6	-	-	
Rated Voltage		400	420	450																		
Impedance Ratio	Z(-25°C)/Z(+20°C)	5	6	6																		
	Z(-40°C)/Z(+20°C)	6	-	-																		
Endurance	<table border="1"> <thead> <tr> <th>Test Time</th> <th>10,000 Hrs</th> </tr> </thead> <tbody> <tr> <td>Capacitance Change</td> <td>Within ±20% of initial value</td> </tr> <tr> <td>Tanδ</td> <td>Less than 200% of specified value</td> </tr> <tr> <td>Leakage Current</td> <td>Within specified value</td> </tr> </tbody> </table> <p>* The above specifications shall be satisfied when the capacitors are restored to 20°C after the rated voltage applied with rated ripple current for 10,000 hours at 105°C.</p>					Test Time	10,000 Hrs	Capacitance Change	Within ±20% of initial value	Tanδ	Less than 200% of specified value	Leakage Current	Within specified value									
Test Time	10,000 Hrs																					
Capacitance Change	Within ±20% of initial value																					
Tanδ	Less than 200% of specified value																					
Leakage Current	Within specified value																					
Shelf Life Test	<table border="1"> <thead> <tr> <th>Test Time</th> <th>1,000 Hrs</th> </tr> </thead> <tbody> <tr> <td>Capacitance Change</td> <td>Within ±20% of initial value</td> </tr> <tr> <td>Tanδ</td> <td>Less than 200% of specified value</td> </tr> <tr> <td>Leakage Current</td> <td>Within specified value</td> </tr> </tbody> </table> <p>* The above specifications shall be satisfied when the capacitors are restored to 20°C after exposing them for 1,000 hours at 105°C without voltage applied. The rated voltage shall be applied to the capacitors before the measurements (Refer to JIS C 5101-4 4.1).</p>					Test Time	1,000 Hrs	Capacitance Change	Within ±20% of initial value	Tanδ	Less than 200% of specified value	Leakage Current	Within specified value									
Test Time	1,000 Hrs																					
Capacitance Change	Within ±20% of initial value																					
Tanδ	Less than 200% of specified value																					
Leakage Current	Within specified value																					
Ripple Current and Frequency Multipliers	<table border="1"> <thead> <tr> <th>Frequency (Hz)</th> <th>60</th> <th>120</th> <th>500</th> <th>1k</th> <th>10k up</th> </tr> </thead> <tbody> <tr> <td>Multipliers</td> <td>0.80</td> <td>1.00</td> <td>1.25</td> <td>1.40</td> <td>1.50</td> </tr> </tbody> </table>					Frequency (Hz)	60	120	500	1k	10k up	Multipliers	0.80	1.00	1.25	1.40	1.50					
Frequency (Hz)	60	120	500	1k	10k up																	
Multipliers	0.80	1.00	1.25	1.40	1.50																	

Diagram of Dimensions

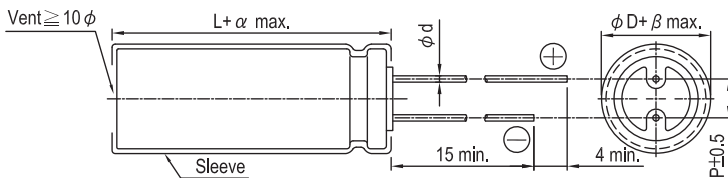

Lead Spacing and Diameter Unit: mm

	10	12.5	16	18
φ D	10	12.5	16	18
P	5.0	5.0	7.5	7.5
φ d	0.6		0.8	
α	2.0			
β	0.5			

Dimension and Permissible Ripple Current Dimension: $\phi D \times L$ (mm)
Ripple Current: mA/rms at 105°C

Rated Voltage (V _{DC})	Cap. (μF)	10 φ			12.5 φ			16 φ			18 φ		
		φ D×L	Ripple Current		φ D×L	Ripple Current		φ D×L	Ripple Current		φ D×L	Ripple Current	
			120 Hz	100k Hz		120 Hz	100k Hz		120 Hz	100k Hz		120 Hz	100k Hz
400V (2G)	33	10×40	315	475									
	39	10×45	360	545									
	47	10×50	420	630	12.5×30	440	660						
	56				12.5×35	500	750						
	68				12.5×40	580	870	16×31.5	530	795			
	82				12.5×50	625	935	16×35.5	615	920			
	100							16×40	715	1,070			
	120							16×40 16×45	800 840	1,200 1,260	18×35.5 18×40	790 870	1,185 1,305
	150							16×50	990	1,485	18×45	985	1,475
	180										18×50	1,120	1,685
420V (2P)	33	10×40	370	555									
	39	10×45	410	615	12.5×30	390	585						
	47	10×50	465	700	12.5×35	450	675						
	56				12.5×40	520	780	16×31.5	500	750			
	68				12.5×45	580	870	16×35.5	580	870			
	82				12.5×50	660	990	16×35.5 16×40	730 675	1,095 1,010			
	100							16×40 16×45	750 755	1,125 1,130	18×35.5	725	1,085
	120							16×50	865	1,300	18×40 18×45	835 880	1,250 1,320
	150										18×50	1,030	1,550
	450V (2W)	33	10×45	330	495	12.5×30	370	555					
39		10×50	380	570	12.5×35	420	630						
47					12.5×40	480	720						
53					12.5×45	500	750						
56					12.5×45	530	795	16×31.5	510	765			
68					12.5×50	620	930	16×35.5	590	885			
82								16×40	615	920	18×35.5	645	965
100								16×45	715	1,070	18×40	750	1,125
120								16×50	820	1,230	18×45	835	1,250
150											18×50	975	1,465

Remark: Other sizes and specification are available, please contact us for detail.

Part Numbering System

RQL Series 39μF ±20% 450V Bulk Package Gas Type 10 φ ×50L Pb-free and PET sleeve

RQL **390** **M** **2W** **BK** - **1050**

Series Name Capacitance Capacitance Tolerance Rated Voltage Lead Configuration and Package Rubber Type Case Size Lead Wire and Sleeve type

Note: For more details, please refer to "Part Numbering System (Radial Type)" on page 13.